



## Install your power supply module

The Trend Micro™ TippingPoint™ power supply module is a replacement unit and can only be used with the following TippingPoint devices:

- Threat Protection System (TPS) TX Series 8200TX and 8400TX devices, and TPS 2200T devices
- Intrusion Prevention System (IPS) NX-Platform devices
- Next Generation Firewall (NGFW) appliances

You cannot use the power supply module as a standalone product.

The replacement power supply kit includes the following items:

- Power supply module
- Documentation

### Power supply module

All of the supported TippingPoint security devices contain two power supply slots and support AC power. The TPS TX Series devices and IPS NX-Platform devices also support DC power supply modules.

---

**Warning:** Do not attempt to install a DC power supply module into an NGFW appliance. The NGFW appliance does not contain the grounding capability for safe installation of a DC power supply module. Bodily harm and damage to the system could result.

---

All power supply modules are redundant and hot-swappable.

**Figure 1. TippingPoint AC power supply module**

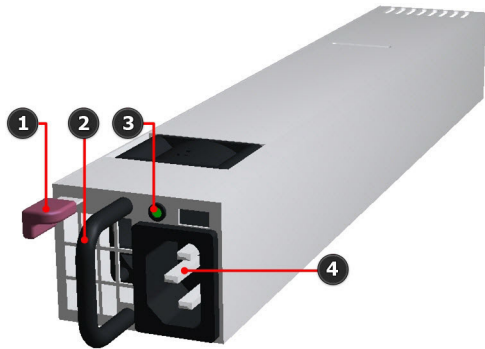

1. Removal Latch
2. Handle
3. Status LED
4. AC male power input

The TippingPoint DC power supply module is similar to the AC power supply module, except that it includes external grounding and a power input terminal block instead of the male power input.

## Identify the faulty power supply module

Before you begin, determine which power supply module is faulty and needs to be replaced. You can review the power supply status with the `show health` command in the command line interface (CLI). You can also check the power supply LED:

- Green: The power supply is running normally.
- Off: The power supply is faulty.

**Figure 2. TippingPoint TX Series TPS devices - back panel**

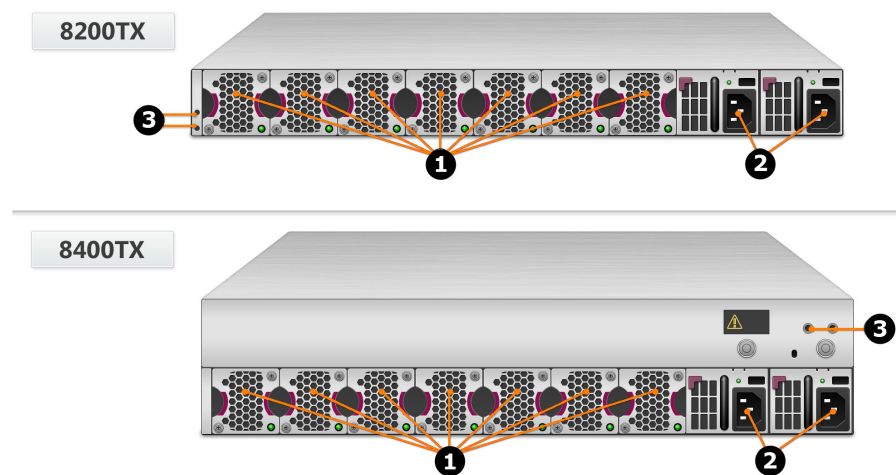

1. Fan modules - fans are numbered from left to right (Fan 1 is on the left; Fan 7 is on the right)
2. Power supply modules (Power supply 1 is on the left; Power supply 2 is on the right)
3. DC grounding lug screw holes

**Figure 3. TippingPoint IPS NX-Platform device - back panel**



1. Ground strap mounting
2. Power supply module (Power supply 1 is on the left; Power supply 2 is on the right)
3. Fan module - fans are numbered from left to right (Fan 1 is on the left; Fan 5 is on the right)

**Figure 4. TippingPoint TPS 2200T device and NGFW appliance - back panel**

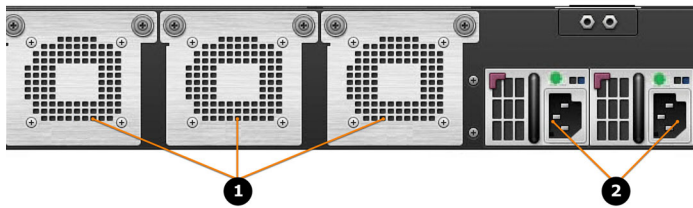

1. Fan modules (Rear fan far from power supply is on the left; Rear fan in the center is in the center; Rear fan near power supply is on the right)
2. Power supply modules (Power supply 2 is on the left; Power supply 1 is on the right)

## Install the replacement power supply module

---

**Note:** The replacement power supply module is hot-pluggable. If only one power supply is being replaced, you can remove the faulty power supply module without turning off the device.

---

1. Remove the faulty power supply module by moving the latch to the right while pulling out the module.
2. Set the faulty power supply module aside.
3. Remove the new power supply module from the packaging.
4. Install the new power supply module by sliding it into the open slot. The latch locks into place automatically.

## Connect an AC power supply module

1. Locate the male power input on the back of the chassis.
2. Plug one end of a standard female power plug into the power input.
3. Plug the other end into an AC outlet, power strip, or UPS. The power should meet the following requirements:
  - Voltage: 100 - 240 VAC
  - Current: 12 - 6 Amps
  - Frequency: 47 - 63 Hz

- Depending on the BIOS settings and the state the device was in when the power was unplugged, the device might or might not turn on automatically when power is reapplied. If necessary, turn on the device with the button on the front of the chassis.

## Connect a DC power supply module to TPS TX Series devices and to IPS NX-Platform devices

---

**Warning:** Do not attempt to install a DC power supply module into an NGFW appliance. The NGFW appliance does not contain the grounding capability for safe installation of a DC power supply module. Bodily harm and damage to the system could result.

---

**Warning:** When you install the product, always make the ground connection before you apply power to the unit. You must ground this equipment to an external ground connection. Use a green and yellow 12 AWG ground wire to connect the host to earth ground during normal use. Disconnect the ground connection only when the unit is completely turned off.

---

**CAUTION:** Do not attach a ground wire to the ground screw on the DC power supply module. Attach the ground wire to the DC grounding screw holes at the rear of the device. Refer to [Figure 5](#) for the location on the TPS (TX Series) chassis and to [Figure 6](#) for the location on the IPS (NX-Platform) chassis.

---

**Figure 5. TippingPoint TPS TX Series devices - DC grounding screw holes to accept the lug connector attached to ground**

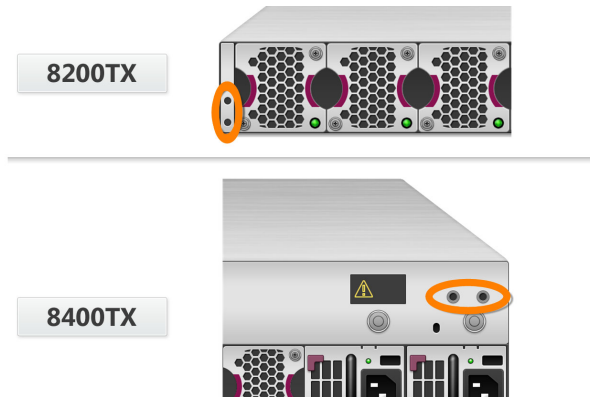

**Figure 6. TippingPoint IPS NX-Platform device - DC grounding screw holes to accept the lug connector attached to ground**



When the DC power supply module has been securely placed in the device, follow these steps to connect power to the DC power supply module.

1. Locate the ground screw on the back of the chassis.
2. Attach a 12 AWG ground wire to the chassis ground strap mounting. The wire should be crimped with a ring lug.
3. Locate the power input terminal block on the back of the module.
4. Attach the 12 AWG DC power wires to the power input terminal block labeled -48V and RTN. The power wires should be crimped with lug spades to ensure a secure connection.
5. Connect the other side of the power cable to the SELV power source. The power source should meet the following requirements:
  - Voltage: -40 to -60 V
  - 24 - 16 Amps
  - SELV
6. Depending on the BIOS settings and the state that the device was in when the power was unplugged, the device may not turn on automatically when power is reapplied. If necessary, turn on the device by using the Power button on the front of the chassis.

## TMC account registration

The TMC provides online access to additional product documentation, updates, and support.

To register for an account, go to <https://tmc.tippingpoint.com>.

## Product support

Information for you to contact product support is available at the [Contact Support](#) site.

## Safety and compliance

TippingPoint products comply with the following safety standards:

- UL 507
- UL 1007
- IEC/EN 60950-1
- CSA C22.2 No. 113-08

## Reduction of hazardous substances

TippingPoint products comply with the RoHS Directive 2011/65/EU.



Trend Micro  
Model Farm Road  
Cork, Ireland  
Eircode T12 VP44

## Waste electrical and electronic equipment



The host product of this custom accessory complies with the labeling requirement of the Waste Electrical and Electronic Equipment (WEEE) Directive 2002/96/EC.

## Turkish recycling notice



Türkiye Cumhuriyeti: EEE Yönetmeliğine Uygundur

## Ukraine compliance statement

Україна: Обладнання відповідає вимогам Технічного регламенту щодо обмеження використання деяких небезпечних речовин в електричному та електронному обладнанні, затвердженого постановою Кабінету Міністрів України від 3 грудня 2008 № 1057.

Ukraine: The equipment complies with requirements of the Technical Regulation, approved by the Resolution of Cabinet of Ministry of Ukraine as of December 3, 2008 No. 1057, in terms of restrictions for the use of certain dangerous substances in electrical and electronic equipment.

## Legal and notice information

© Copyright 2023 Trend Micro Incorporated. All rights reserved.

Trend Micro Incorporated makes no warranty of any kind with regard to this material, including, but not limited to, the implied warranties of merchantability and fitness for a particular purpose. Trend Micro Incorporated shall not be liable for errors contained herein or for incidental or consequential damages in connection with the furnishing, performance, or use of this material.

This document contains proprietary information, which is protected by copyright. No part of this document may be photocopied, reproduced, or translated into another language without the prior written consent of Trend Micro Incorporated. The information is provided “as is” without warranty of any kind and is subject to change without notice. The only warranties for Trend Micro Incorporated products and services are set forth in the express warranty statements accompanying such products and services. Nothing herein should be construed as constituting an additional warranty. Trend Micro Incorporated shall not be liable for technical or editorial errors or omissions contained herein.

TippingPoint, the TippingPoint logo, and Digital Vaccine are trademarks or registered trademarks of Trend Micro Incorporated. All other company and/or product names may be trademarks or registered trademarks of their respective owners. This document contains confidential information, trade secrets or both, which are the property of Trend Micro. No part of this documentation may be reproduced in any form or by any means or used to make any derivative work (such as translation, transformation, or adaptation) without written permission from Trend Micro or one of its subsidiaries.

All other company and product names may be trademarks of their respective holders.

Install your power supply

Edition: August 2023, Rev A2